

Mini Braking High Power Resistors

The MBH/V models are metal-clad, compact high-power resistors designed for industrial and other applications. Our extruded aluminum housing provides rugged and strong protection. These models are specially constructed for overload pulses. They have a thermostat and terminal box as optional. The most common applications for these models are: motor drives, braking and snubber applications and power sources for industrial equipment.



GENERAL SPECIFICATIONS

| Model | Rated Power @25C [W] | Pulse Power [KW] | | | | Resistance Range [Ω] | Tolerance [%] |
|-------------|----------------------|------------------|--------|--------|--------|----------------------|---------------------|
| | | *ED5% | *ED10% | *ED20% | *ED40% | | |
| MBH/V 3000 | 1100 | 17.5 | 8.5 | 4.5 | 2 | 0.4 ~ 150 | J [±5%] K [±10%] |
| MBH/V 3600 | 1300 | 20 | 10 | 5.5 | 2.5 | 0.5 ~ 170 | |
| MBH/V 5000 | 1500 | 24 | 12 | 6 | 3 | 0.6 ~ 180 | |
| MBH/V 7200 | 2000 | 32 | 16 | 8 | 4 | 0.7 ~ 200 | |
| MBH/V 9600 | 2500 | 40 | 20 | 10 | 5 | 0.8 ~ 220 | |
| MBH/V 10800 | 2900 | 46 | 23 | 11.5 | 6 | 1.0 ~ 240 | |

* Referred to a cycle duration of 120s.

CHARACTERISTICS

| | | |
|-------------------------|-------------|---|
| Insulation Resistance | | 20MΩ minimum |
| Dielectric Strength | | Available options : AC1500V,2500V,3500V for 1minute, Max leakage current: 2mA |
| Temperature Coefficient | | ±260ppm/Ω |
| Short Time Overload | ±[5%+0.05Ω] | 5-10×Power rating – in 5~10seconds |
| Moisture Resistance | ±[3%+0.05Ω] | 40°C,95%RH, DC100V case to terminal, 500hours |
| Thermal Shock | ±[3%+0.05Ω] | Power rating 30minutes, -40°C 15minutes |
| Moisture Load Life | ±[3%+0.05Ω] | 40°C,95%RH, 0.1×power rating, 1.5hours on, 30minutes off, 500hours |
| Load Life | ±[5%+0.05Ω] | Power rating 1.5hours on, 30minutes off, 500hours |

SURFACE TEMPERATURE INCREASE VERSUS POWER LOAD & DERATING CURVE

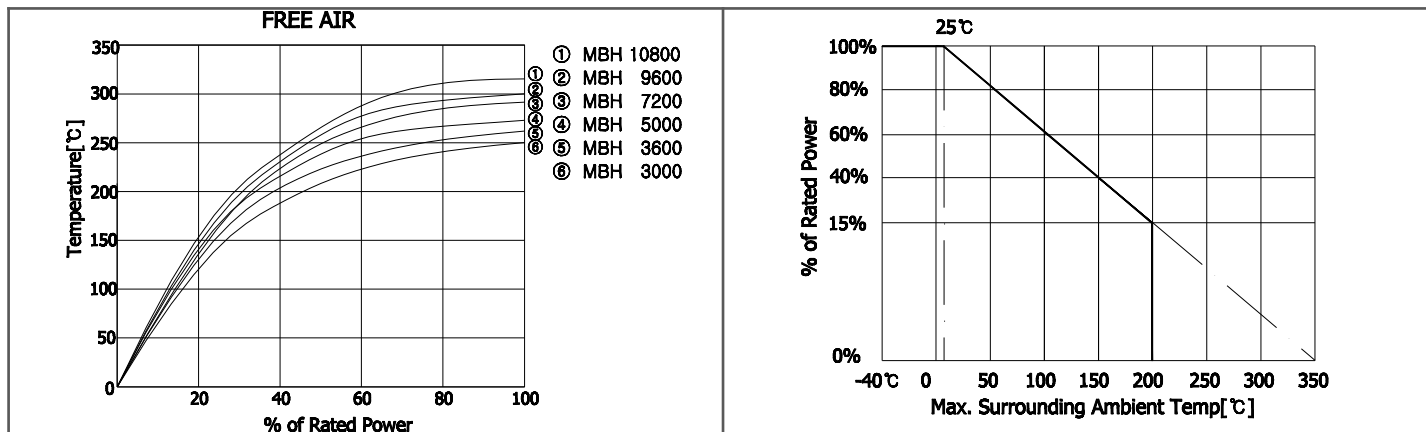

MBH DIMENSIONS [mm]

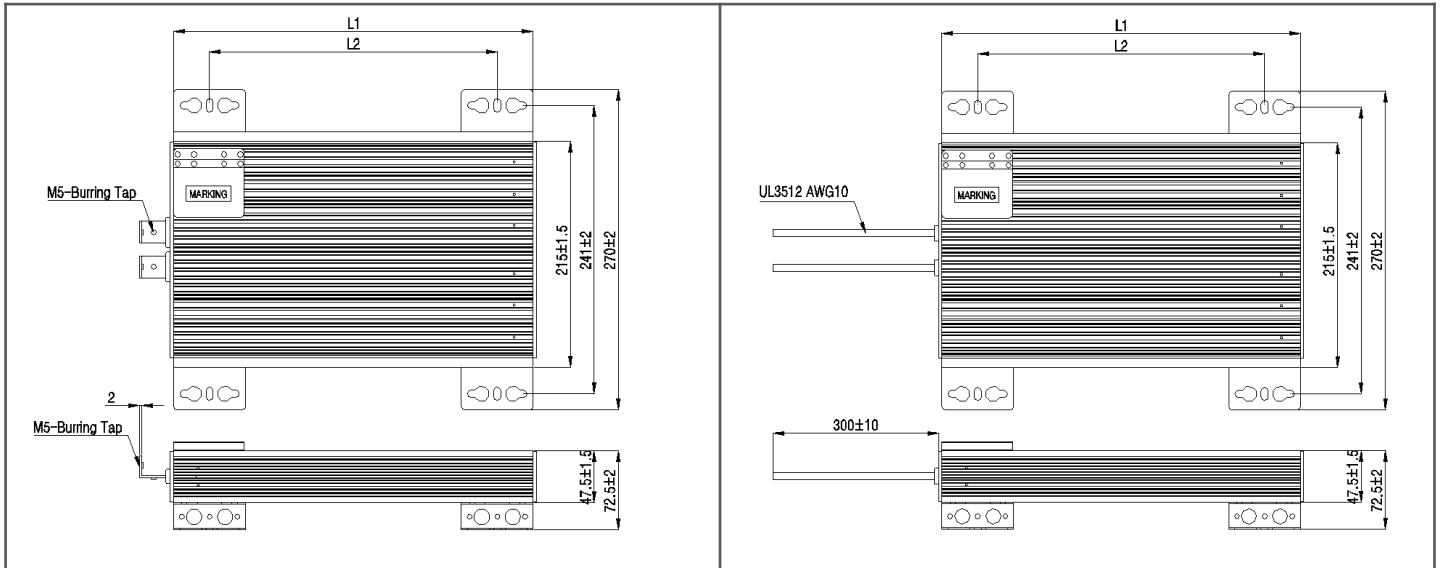

| Model | L1±2 | L2±2 | Weight [Kg] |
|-----------|------|------|-------------|
| MBH 3000 | 330 | 264 | 7.2 |
| MBH 3600 | 400 | 334 | 8.2 |
| MBH 5000 | 460 | 394 | 9.0 |
| MBH 7200 | 560 | 494 | 10.5 |
| MBH 9600 | 660 | 594 | 12.0 |
| MBH 10800 | 760 | 694 | 13.5 |

MBV DIMENSIONS [mm]

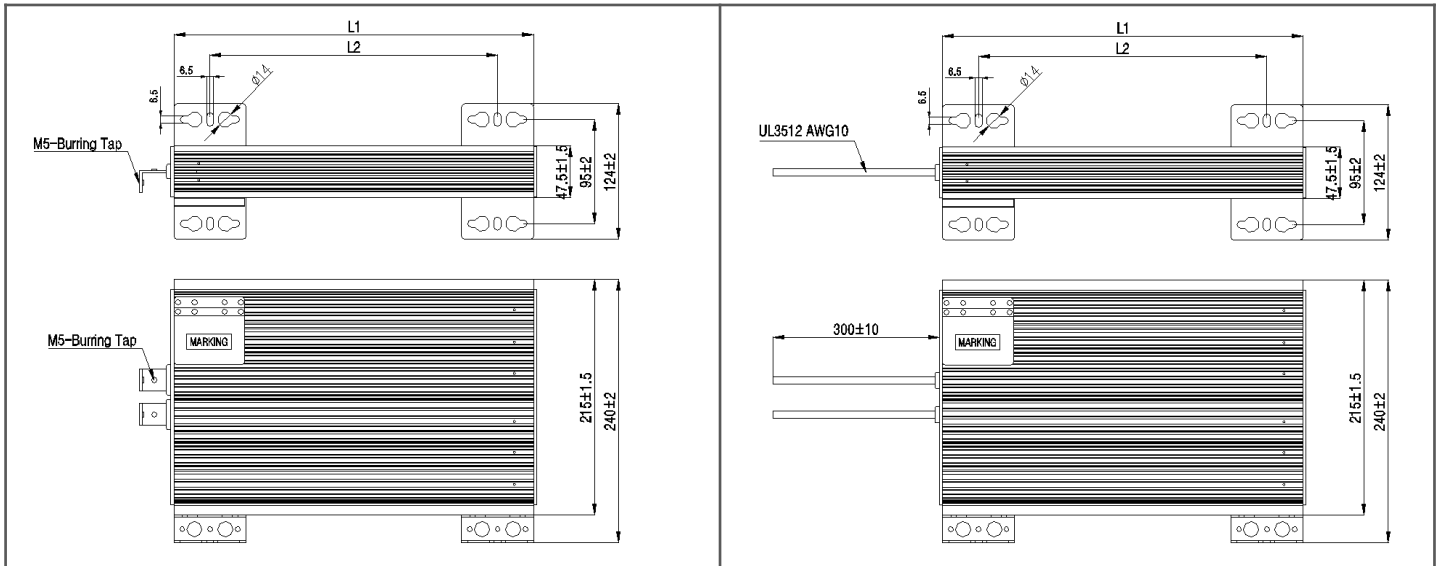

| Model | L1±2 | L2±2 | Weight [Kg] |
|-----------|------|------|-------------|
| MBV 3000 | 330 | 264 | 7.2 |
| MBV 3600 | 400 | 334 | 8.2 |
| MBV 5000 | 460 | 394 | 9.0 |
| MBV 7200 | 560 | 494 | 10.5 |
| MBV 9600 | 660 | 594 | 12.0 |
| MBV 10800 | 760 | 694 | 13.5 |

SCREW-MOUNTING HOLE DIMENSIONS [mm]

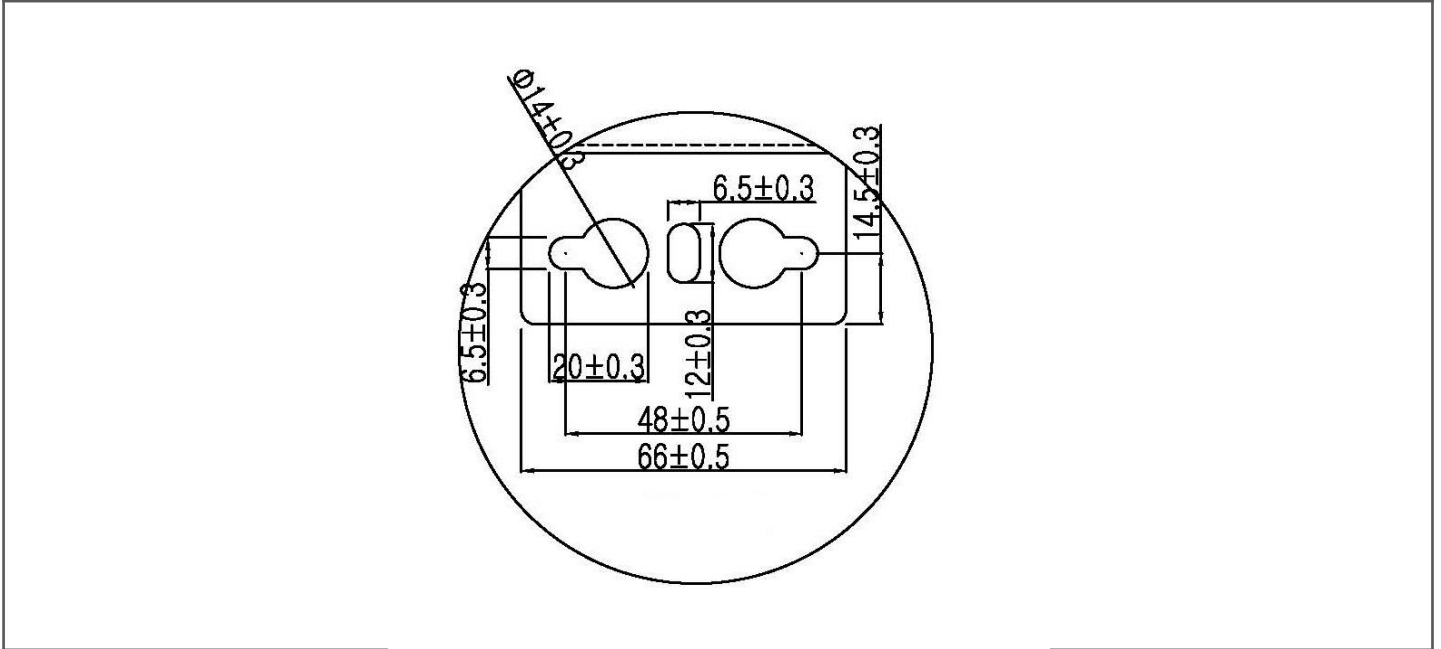

ORDERING PROCEDURE EXAMPLE

