

Metal Clad Wire Wound Resistors

The LFH(H=Horizontal) models are our standard wire wound, metal-clad resistors. These models have an extruded aluminum housing providing strong and rugged protection.

The most common applications for these models are : Motor drives, braking and snubber applications, charging for electric vehicles and power sources for industrial equipment.



GENERAL SPECIFICATIONS

MODEL	RATED POWER [W] (On Heatsink)	RESISTANCE RANGE [Ω]		TOLERANCE
		INDUCTIVE	NON-INDUCTIVE	
LFH 300	300	0.1~500	0.1~200	F [$\pm 1.0\%$] J [$\pm 5.0\%$] K [$\pm 10\%$]
LFH 400	400	0.1~600	0.1~300	
LFH 500	500	0.1~600	0.1~300	
LFH 600	600	0.1~800	0.1~350	
LFH 800	800	0.1~1.0K	0.1~500	
LFH 1000	1000	0.1~1.5K	0.1~700	
LFH 1200	1200	0.1~2.0K	0.1~1.0K	
LFH 1500	1500	0.1~5.0K	0.1~2.0K	
LFH 2000	2000	0.1~7.0K	0.1~3.0K	

CHARACTERISTICS

TEST	CONDITIONS
DIELECTRIC WITHSTANDING VOLTAGE	AC 2500V for 1minutes (Leakage current : 5mA)
INSULATION RESISTANCE	100M Ω at 500Vdc
HEAT RESISTANCE	$\pm [5\% + 0.05\Omega]$ 180°C, 2hours

DERATING CURVE

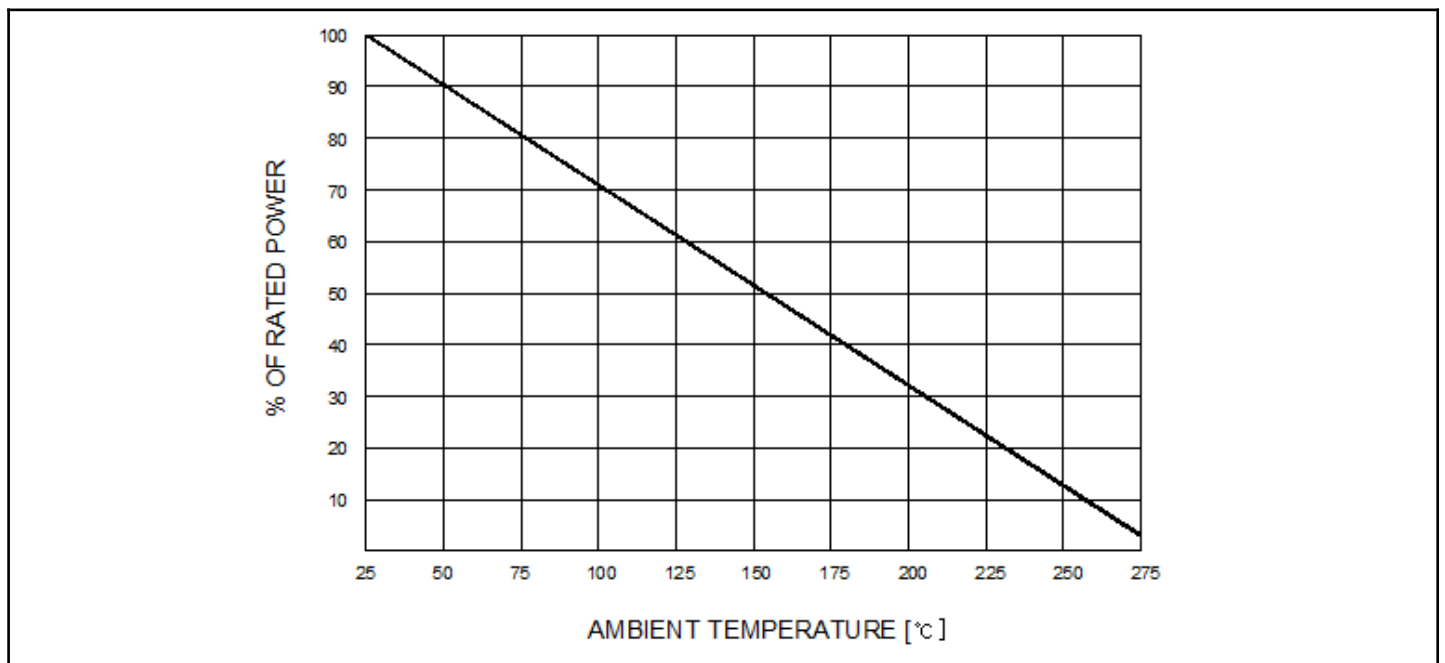

DIMENSIONS[mm]

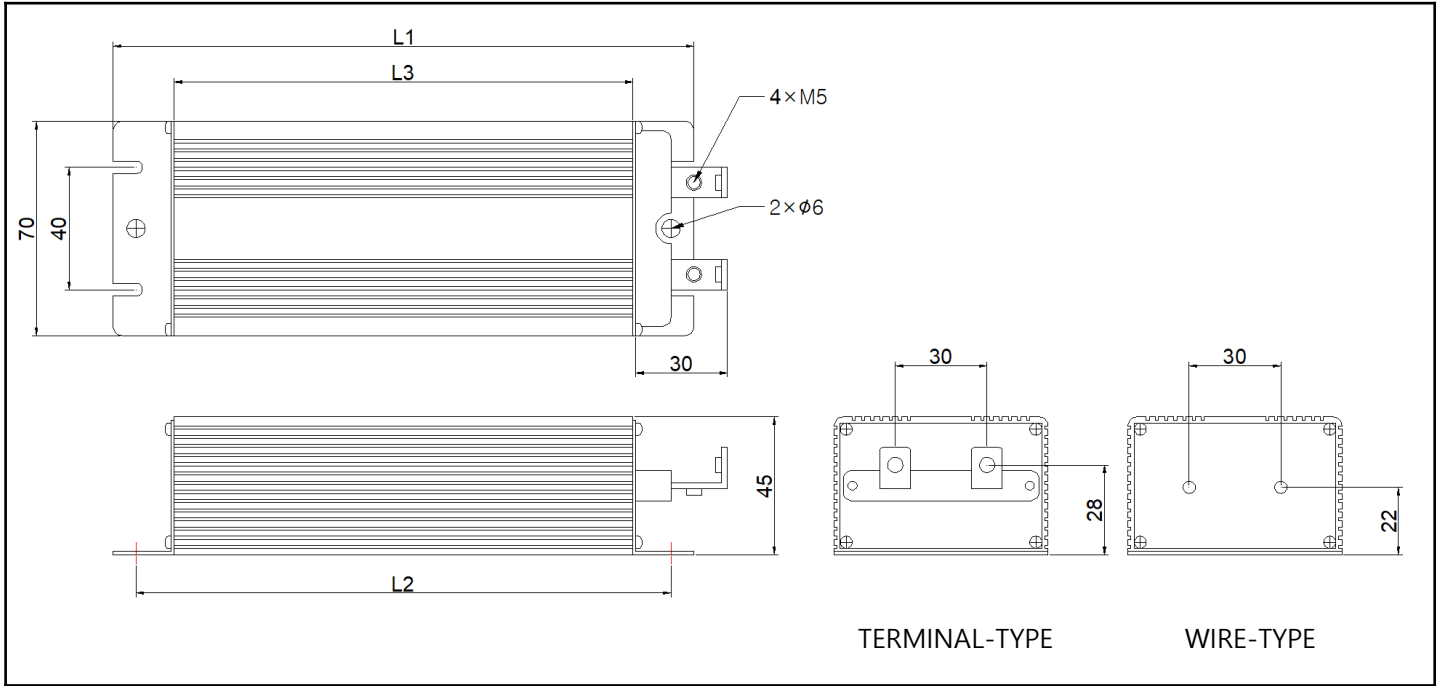

MODEL	L1±1.5	L2±1.5	L3±1.5
LFH 300	190	175	150
LFH 400	220	205	180
LFH 500	240	225	200
LFH 600	260	245	220
LFH 800	300	285	260
LFH 1000	240	325	300
LFH 1200	400	385	360
LFH 1500	440	425	400
LFH 2000	510	495	470

ORDERING PROCEDURE EXAMPLE

